



GAMPACK GROUP

Customizing Packaging Technology

THE COMPANY

Gampack Group, born from the strategic union of two Italian companies, stands out on the secondary packaging plant market with complete and highly customized end-of-line solutions. Thanks to continuous desire for research and the long experience gained, the Group represents the ideal technological partner capable of responding to the increasingly diversified needs of customers.



THE STORY

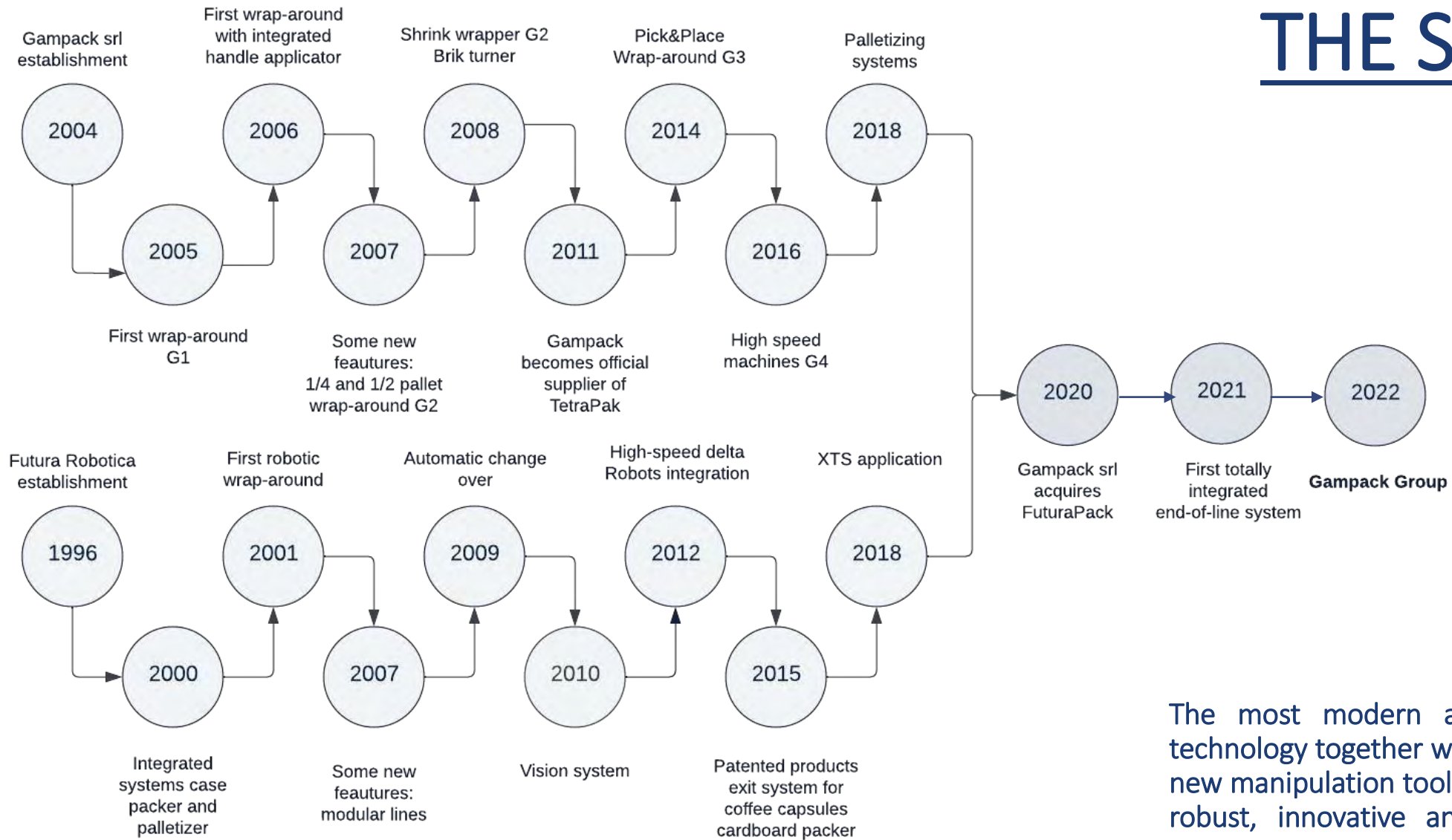

The most modern and safe mechanical technology together with the robotics of the new manipulation tools for the recreation of robust, innovative and flexible packaging systems.



THE PLANT

- Main plant of 5.000 m²
- Secondary plant of 3.200 m²
- Sales office directly linked to the technical/production/assistance department
- Mechanical and electrical assembly area
- Strategic position, near the main point of access to the city
- Direct access for trucks inside the plant for the loading operations

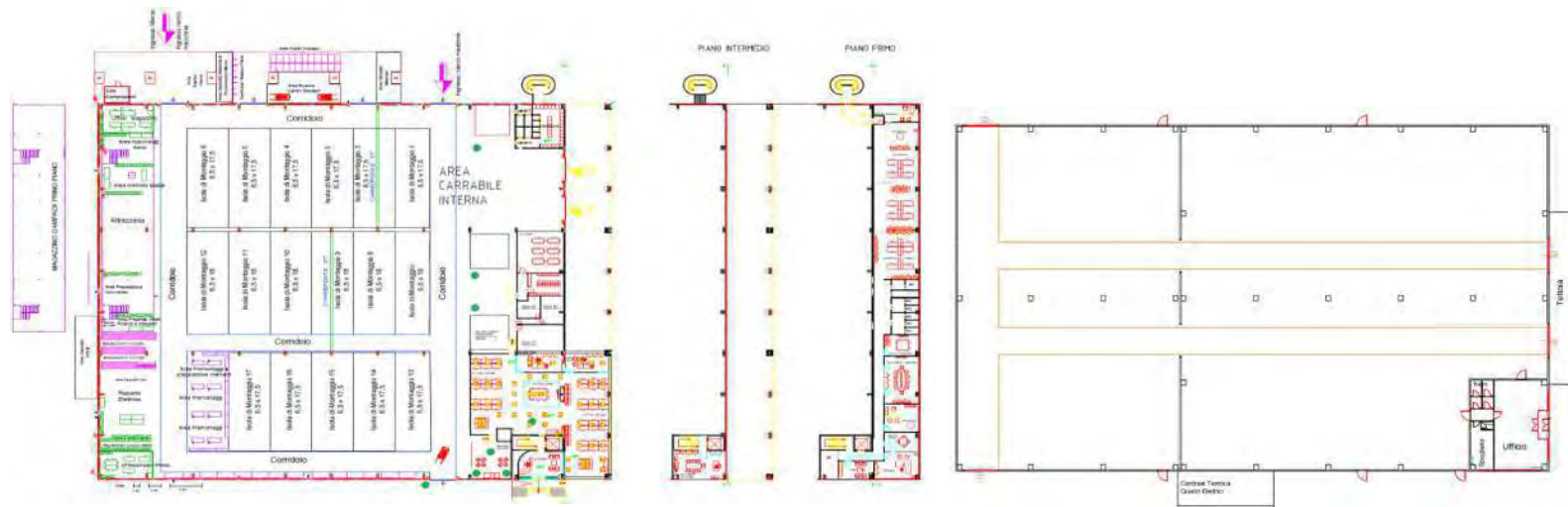

THE VALUES

- Fully satisfying customer requests, designing highly customized and specific machines for every need
- Improving systems, programs and processes to provide innovative, efficient and reliable products
- Realizing high quality systems, through the collaboration of consolidated and reliable suppliers and experienced and qualified internal staff
- Developing plastic-free, sustainable and environmentally friendly solutions
- Providing timely technical assistance and spare parts, to respond to customer needs in the shortest possible time
- Building lasting partnerships with customers, supporting them with automated, flexible and fast solutions, which allow a reduction in operating costs and an increase in performance



GLOBAL FOOTPRINT

- Machine installed in 54 countries
- 1400 references
- 125 internal collaborators and agents located around the world
- Sales department and after sales service in the main languages: English, French, Spanish, German and Italian



Headquarters: Via Piemonte 1, 29122 Piacenza ITALIA

DESIGN AND DEVELOPMENT

- Gampack Group's goal is to create each single machine according to the needs of every customer, offering efficient, fast, flexible and long-lasting products
- Starting from the analysis of the customer's needs, the technical team and the sales department design and propose tailor-made and highly personalized solutions
- Each offer comes with a layout, to allow the customer to evaluate the solution at 360°
- The many years of experience in the secondary packaging sector, combined with the research activities of the technical department allow us to offer cutting-edge machines



AFTER-SALES SUPPORT

- A network of expert technicians to support customers in the main European languages: English, French, Spanish and Italian
- Remote assistance service to allow remote and real-time connection to the machine program
- 24/7 telephone assistance to promptly respond to emergency situations
- On-site interventions to resolve any malfunctions that cannot be resolved through remote assistance
- Scheduled maintenance plans (preventive, ordinary and extraordinary) to ensure maximum machine efficiency over time
- Education and training courses for operators to provide the right combination of theoretical notions and practical exercises for safe use of the machine
- Main spare parts available in stock to ensure rapid replacement in case of breakage or malfunction



MARKETS & PRODUCTS

- Dairy industry
- Vegetable drinks
- Soft drinks and alcoholic beverages
- Pet food
- Food industry
- Home care and personal hygiene
- Pharmaceutical Industry



PRIMARY PACKS WORKED OUT



CANS



TINS



JARS



DOYPACKS



FLOWPACKS



POUCHES



COFFEE CAPSULES



BEVERAGE CARTONS



PET, GLASS & HDPE BOTTLES

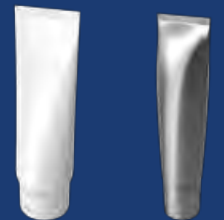

TUBES



PLASTIC CUPS



VIALS

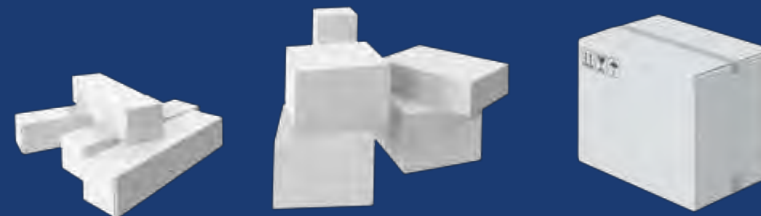

CARTON BOXES

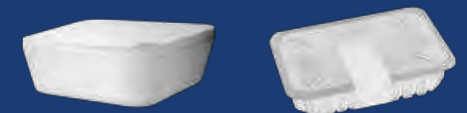

THERMOFOILED TRAYS

Dairy



Pharmaceutical Industry



Pet food



Others



SOME OF OUR CUSTOMERS

Beverage



Food Industry





OUR SOLUTIONS

The added value of the combination of tradition and innovation

- Wrap-around case packers
 - Shrink wrappers
 - Handle applicators
 - Pick & Place
 - Cluster machines
 - Accumulation systems
-
- Vertical case packers
 - Modular cartoning machines
 - Palletisation systems
 - Integrated solutions

WRAP-AROUND CASE PACKERS

Model	Packaging	Product	Speed
GAP-TRAY	Tray	Bottles, cans, jars	From 18 to 120 ppm
GAP-TRAYB		Beverage cartons	From 18 to 120 ppm
GAP-W	Wrap-around cardboard case	Bottles, cans, jars	From 18 to 120 ppm
GAP-WB		Beverage cartons	From 18 to 120 ppm
GAP-MW	Wrap-around cardboard case + handle	Bottles, cans, jars	From 18 to 60 ppm
GAP-MWB		Beverage cartons	From 18 to 60 ppm

- Customized solutions
- High-speed performance
- Protection of the product from light, dust and possible impacts in the logistic phases
- Additional modules for ½ pallet e ¼ pallet
- Additional module for cover application on tray
- Easy handling and placing on pallet for transport



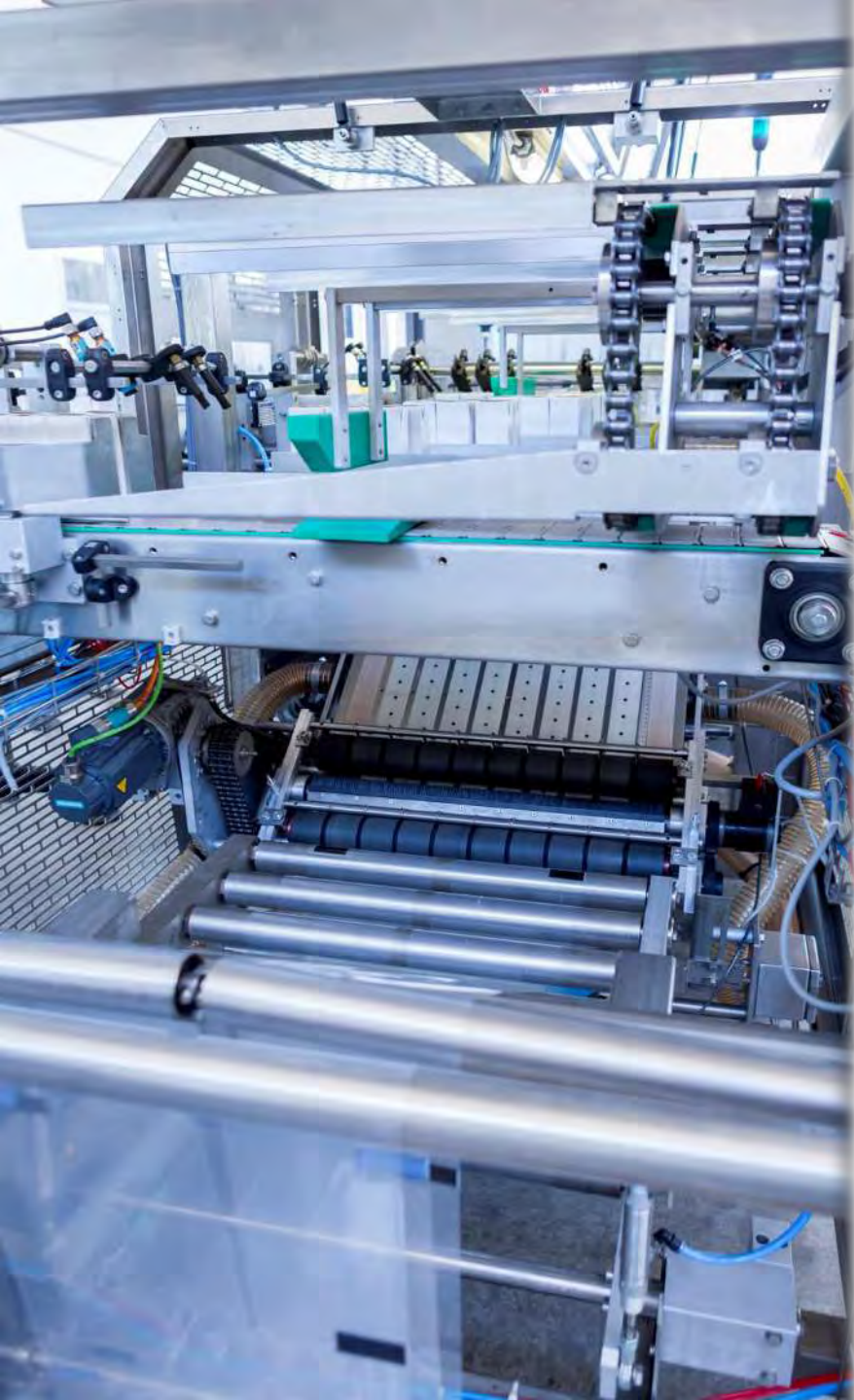

SHRINK WRAPPERS

Model	Packaging	Product	Speed
GAP-F	Film	Bottles, cans, jars	From 18 to 160 ppm
GAP-FB		Beverage cartons	From 18 to 160 ppm
GAP-P	Pad + film	Bottles, cans, jars	From 18 to 100 ppm
GAP-PB		Beverage cartons	From 18 to 100 ppm
GAP-T	Tray + film	Bottles, cans, jars	From 18 to 60 ppm
GAP-TB		Beverage cartons	From 18 to 60 ppm

- Customized solutions
- High-speed performance
- Compatibility with different types of film
- Possibility of using recycled film
- Compact dimensions
- Automatic centralized lubrication
- Possibility of inserting vertical interlayer or advertising flyer

ALL-IN-ONE

Few samples of possible formats

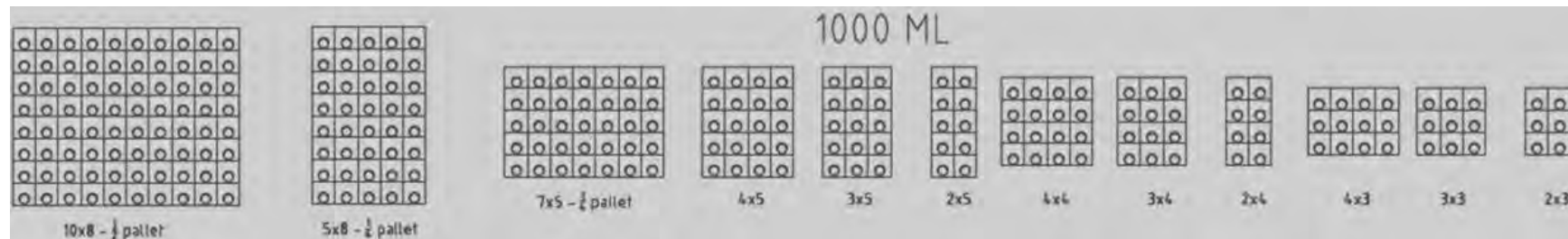
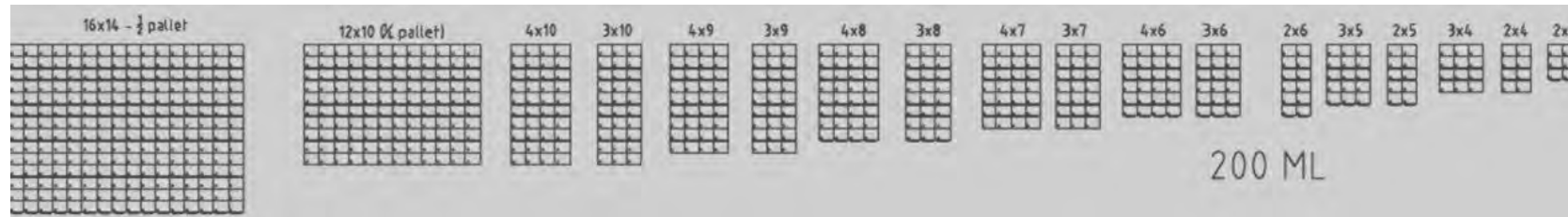
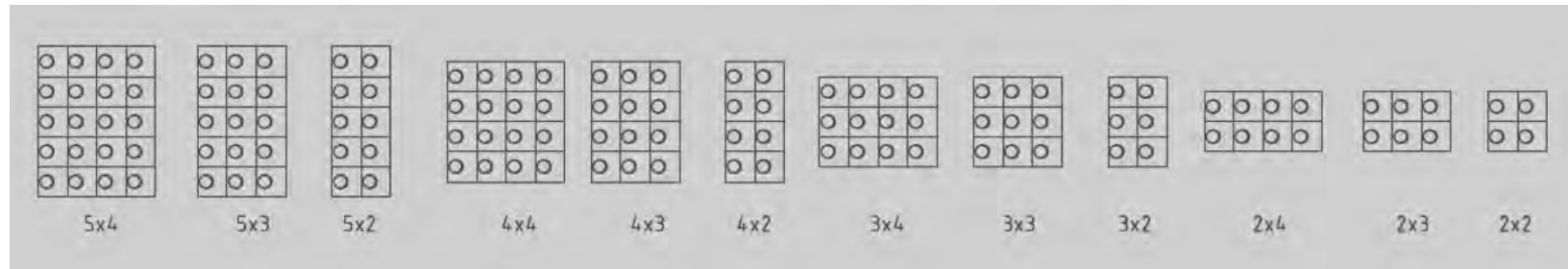

INTEGRATED SOLUTIONS

- Combination of different machines in a single system, with the possibility of choosing the type of packaging each time, as necessary
- Union of different modules in a single frame to generate savings in terms of dimensions, consumption and man/machine interface
- Flexibility of the solutions, to facilitate adaptation to the product to be packaged
- Additional modules:
 - Layers overlapping module
 - Wrap-around formation module
 - Cover application module
 - Over flap application module
 - Film wrapping module
 - Handle applicator module



HANDLE APPLICATORS

STAND ALONE handle applicators

- Automatic stand alone machine for the application of self-adhesive handles on wrap-around/trays/shrink-wrapped packs
- Handle application when the packs pass through (on both its fore and back side), thanks to pneumatic arms
- Cutting unit equipped with a cam-driven blade for the adhesive tape cut
- Transparent mono-oriented polypropylene handle-tape, which could be also laminated with cardboard which could be blank, coloured or printed with advertising signs and/or images
- Electronic centering of the handle and the possible label, allowing the machine to catch up on possible mistakes and performing the re-positioning automatically.
- Possibility of changing both handle size and its tension

INTEGRATED handle applicators

- Machine for the application of self-adhesive handles on wrap-around/trays packs, integrated to cardboard packers
- Handle application when the packs pass through (on both its fore and back side), thanks to pneumatic arms
- Cutting unit equipped with a cam-driven blade for the adhesive tape cut
- Transparent mono-oriented polypropylene handle-tape, which could be also laminated with cardboard which could be blank, coloured or printed with advertising signs and/or images
- Electronic centering of the handle and the possible label, allowing the machine to catch up on possible mistakes and performing the re-positioning automatically.
- Possibility of changing both handle size and its tension

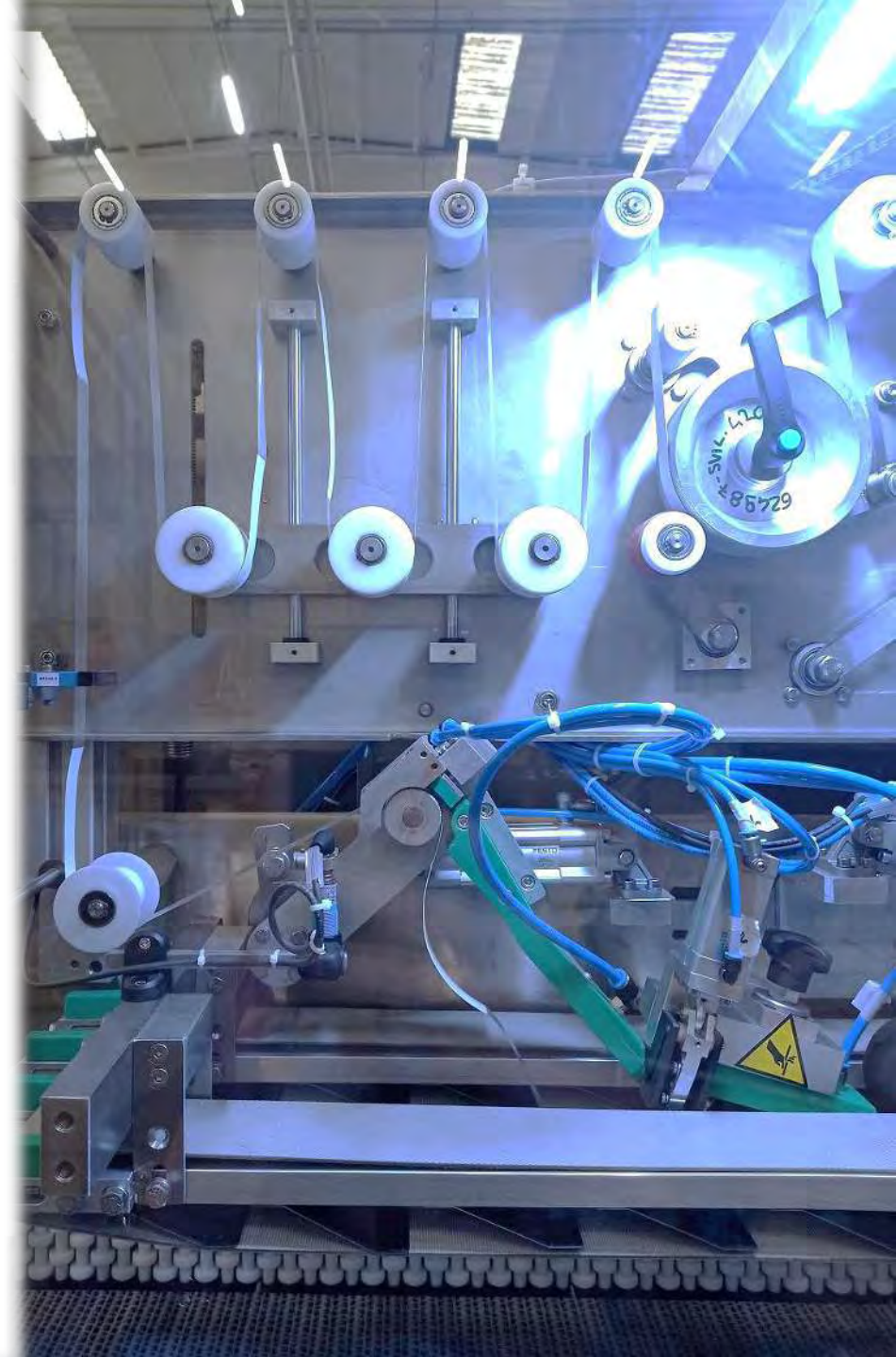

ACCUMULATION SYSTEMS

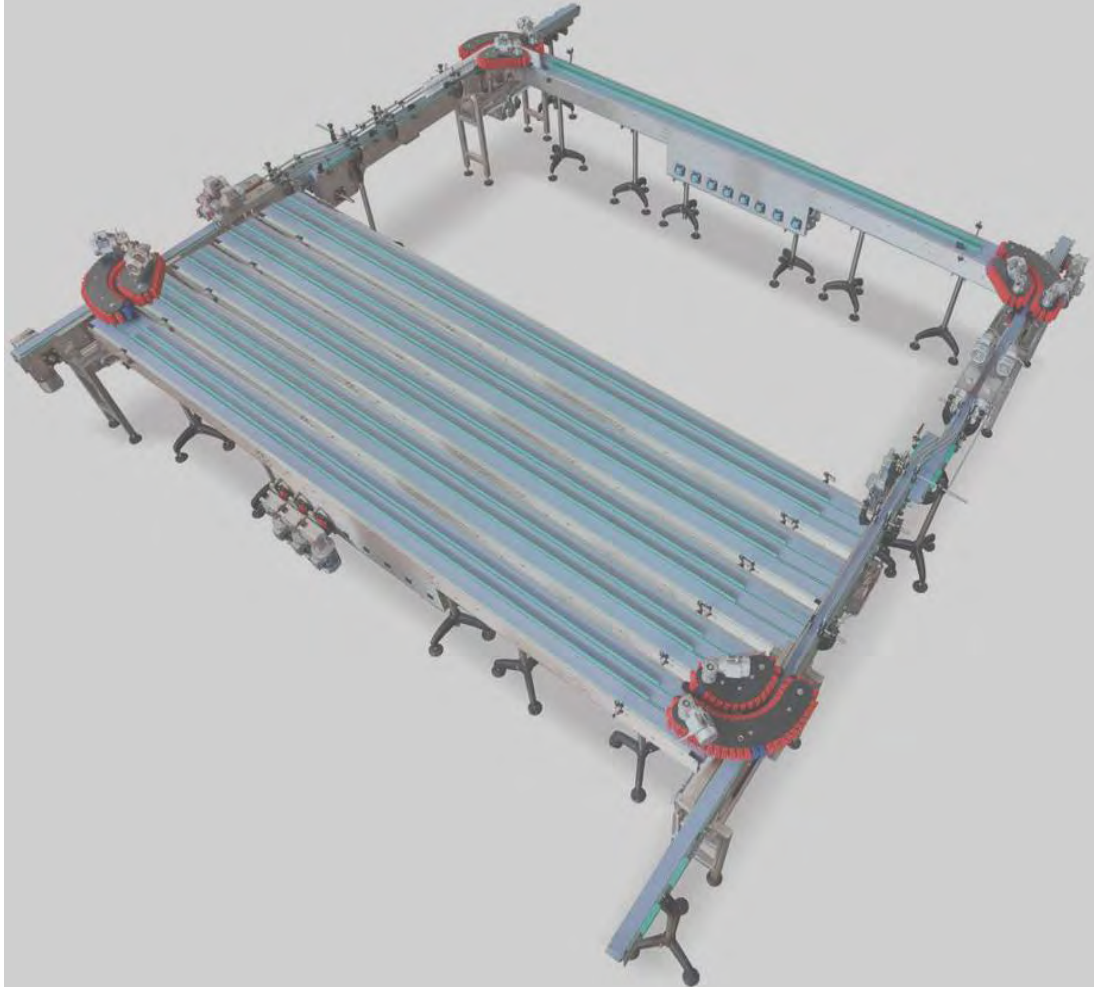

- The accumulation table is a buffer tailored to allow the recovery of productivity in the case of micro-stops of the packaging machine positioned downstream, thus allowing the filler to avoid continuous stopping.
- The purpose of the accumulation table is to divert the flow of product from the filler to several motorized lanes that can temporarily store them. At the downstream machine's product demand, the ACT will empty at a higher speed than the main line, thus restoring the correct workflow.
- Model ACT accumulation table is designed following the FIFO method, first in first out, as this is more suitable for fresh products and allows a perfect traceability of the product itself.

A FEW EXAMPLES





VERTICAL CASE PACKERS

Model		Package dimension [L,W,H]		
V15	Min	200	130	80
	Max	600	400	380
V20	Min	200	130	120
	Max	600	400	460
V30	Min	100	50	100
	Max	300	200	280

- Specific solutions for American box
- Adhesive tape or glue closure
- Integration with anthropomorphic, delta, polar or three-axis controlled robot
- Customized picking head according to the product to be taken
- Robustness and versatility
- High performance

- Solid and reliable, these machines represent the perfect combination of the modern and safe mechanics with the robotics of the latest handling systems.
- They are equipped with handling systems for incoming products and gripping heads designed on the basis of our clients' needs.
- They are provided with a touch screen operator panel for automatic format change, remote assistance and integrated diagnostics.

Product flow

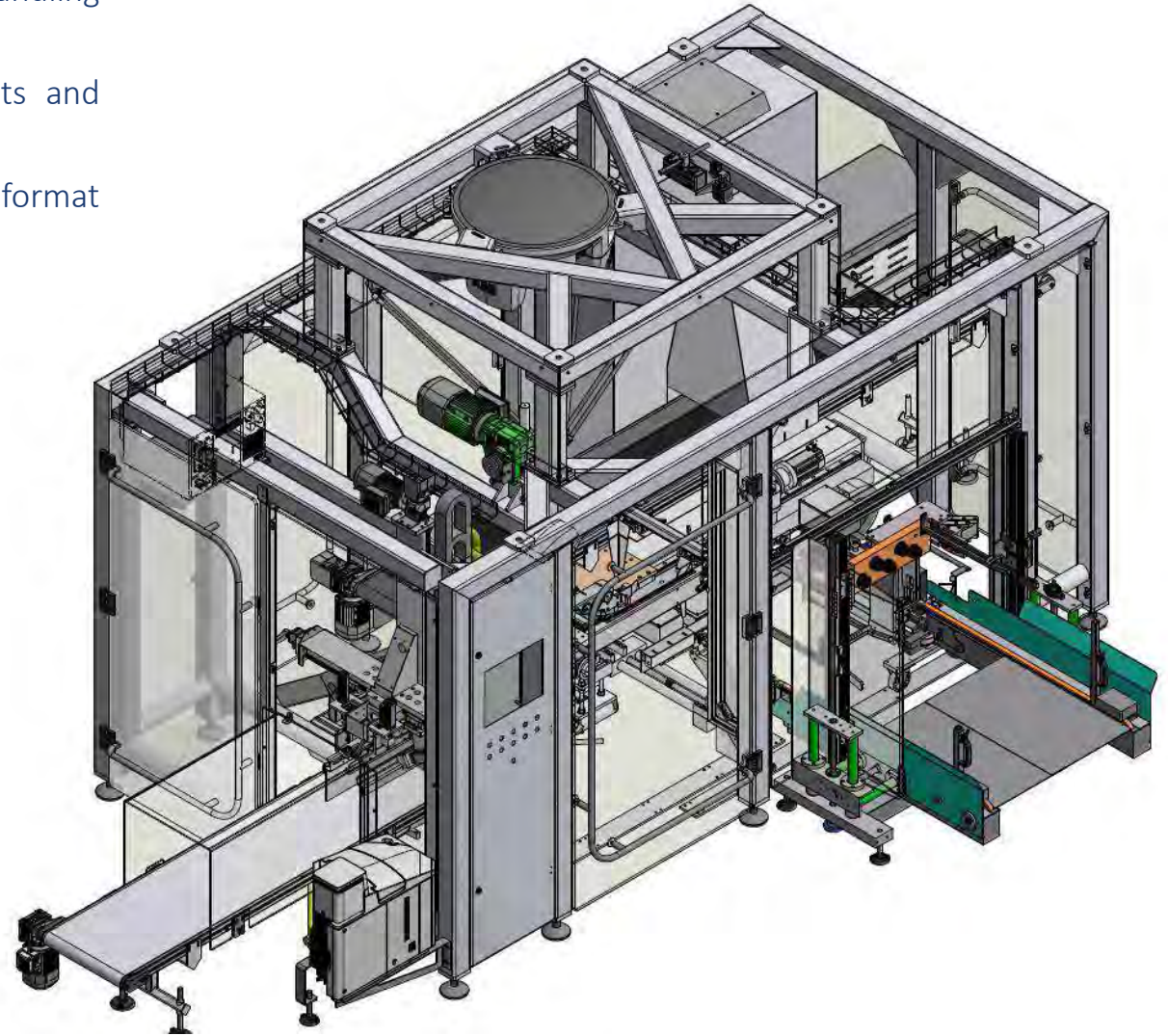
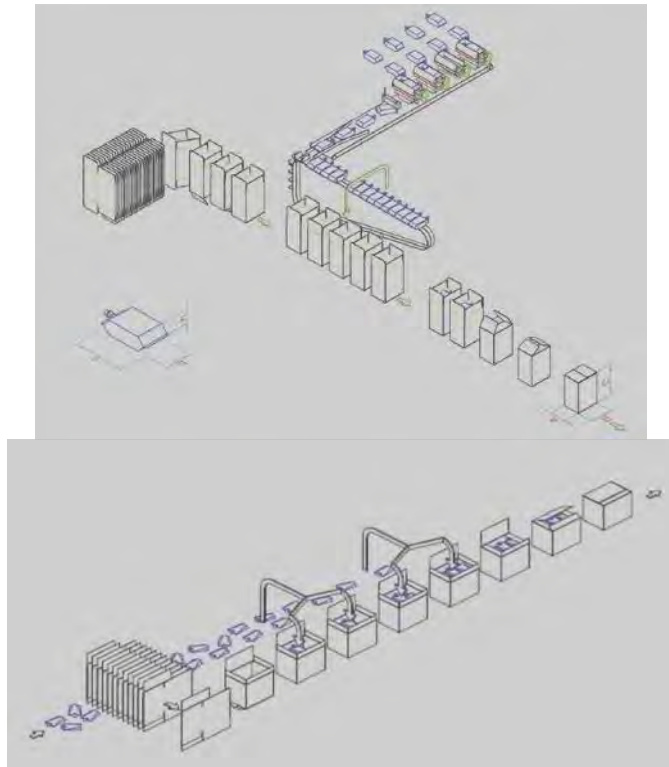

MODULAR CARTONING MACHINES

Mod. Roboline/MP

- Customized solutions
- High-speed performance
- Combination of functional modules equipped with latest generation robot manipulators
- Suitable for any type of pre-glued cardboard packaging from flat blank, wrap-around and trays with or without lids
- Package filling by manipulator robots for single picking of the products
- Management of products arriving from the upstream machine, arranged in bulk
- Modules for packaging formation, for filling the package and for subsequent closure standardized for high repeatability and reliability
- Versatility and efficiency



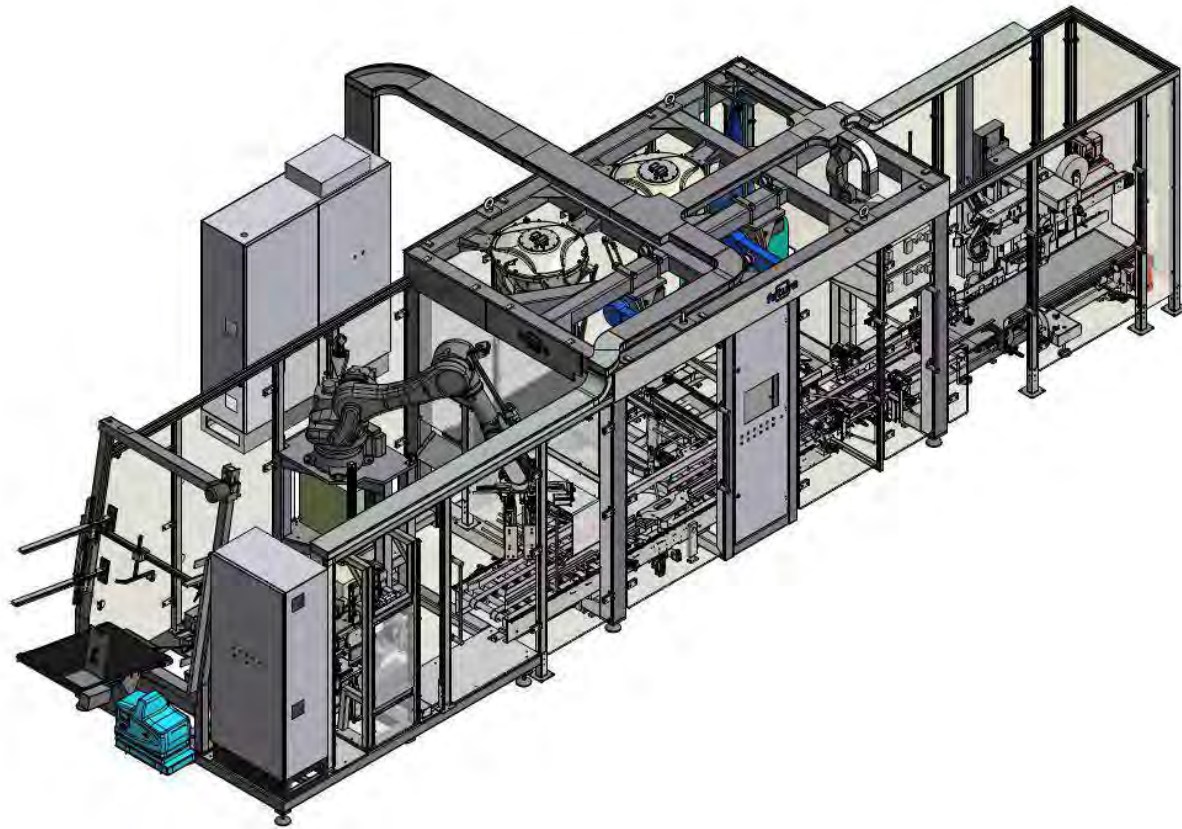

Product flow

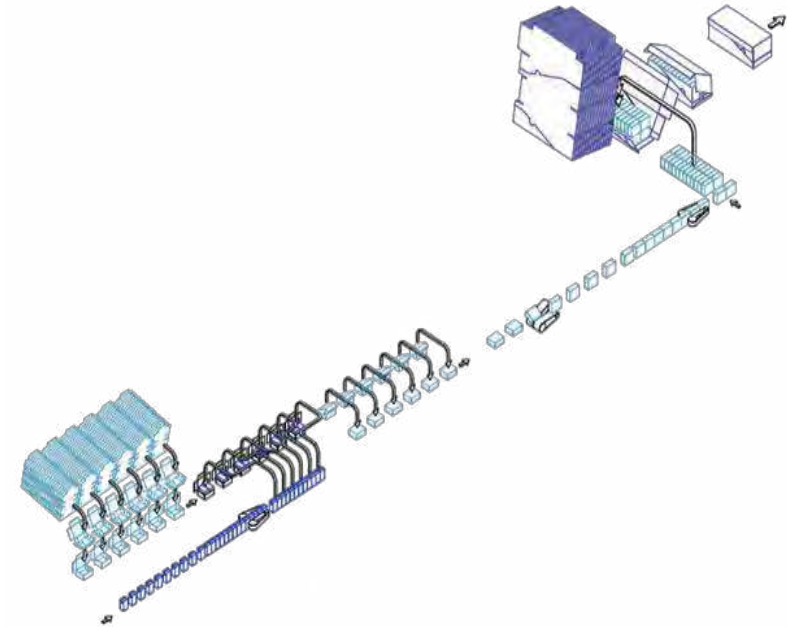

- Composition in replicable functional modules.
- The combination of functional modules and the use of vision systems and handling robots make this type of line the maximum expression of versatility.
- For all types of packaging which need to be handled vertically, on the edge or horizontally, in pre-glued cartons or from a flat blank, wrap-around, trays with or without a lid (both outer and inner).
- They can receive items which arrive randomly from the upstream machine.

WRAP-AROUND CASE PACKERS

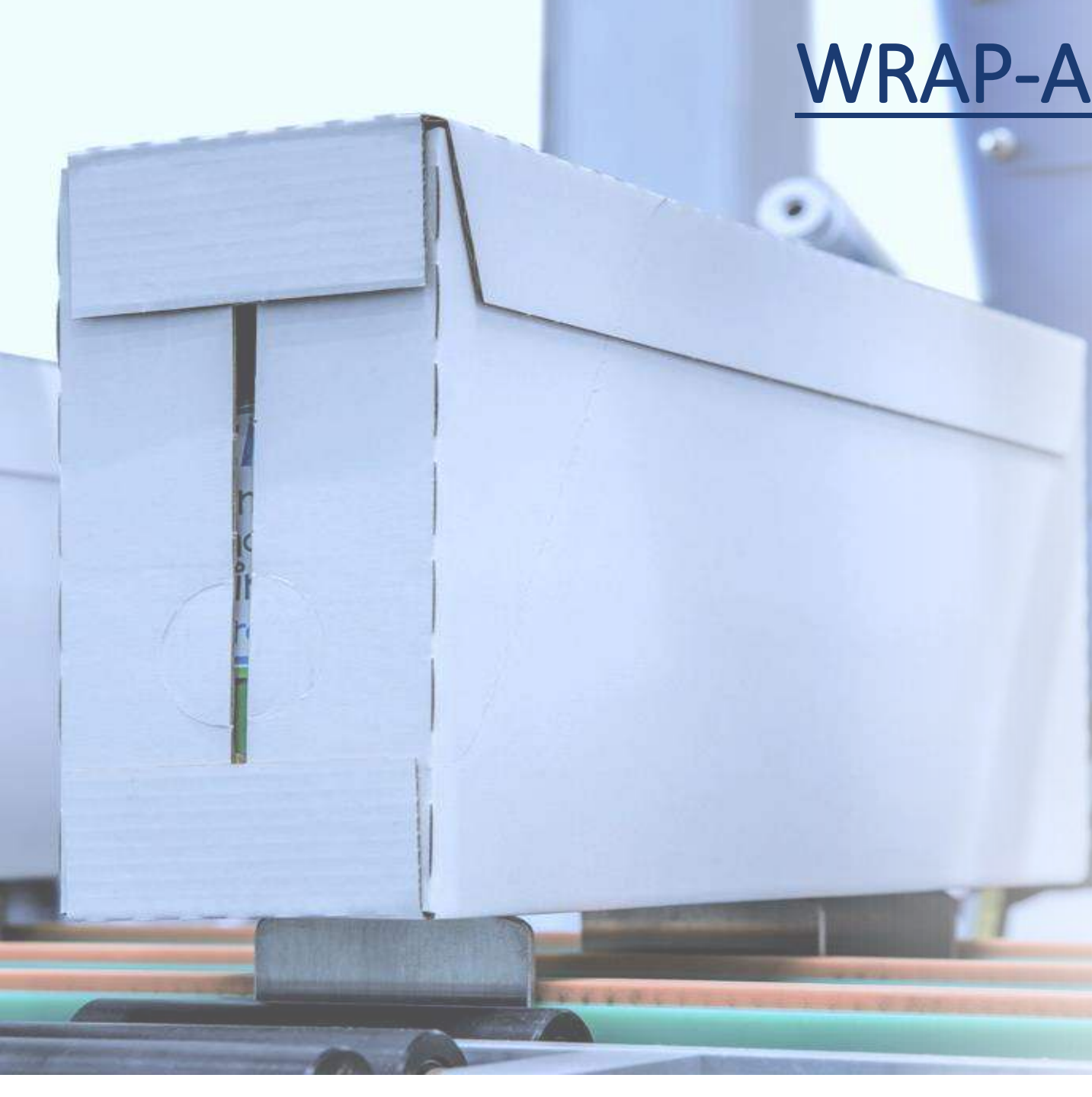

Model		Package dimension [L,W,H]		
W15	Min	180	100	80
	Max	500	360	360
W25 base	Min	230	80	100
	Max	400	300	300
W25 big formats	Min	230	80	100
	Max	600	400	400

- Specific solutions for wrap-around cardboard boxes (entirely closed or open trays) made from flat blanks.
- Combination between the modern and safe mechanics with the robotics of the latest handling systems.
- Integration of input product handling systems and gripping heads designed according to client's requirements.
- Robustness and versatility.
- Possibility to integrate lid application with model W25.

Product flow

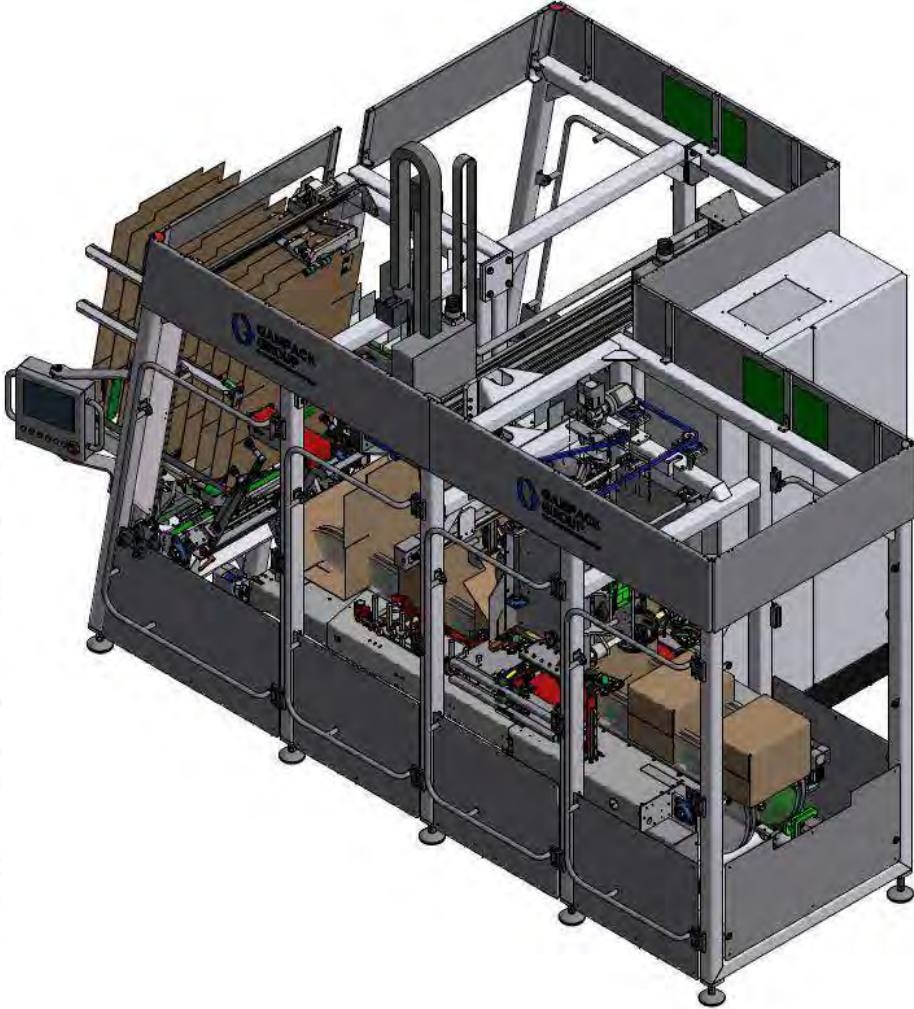
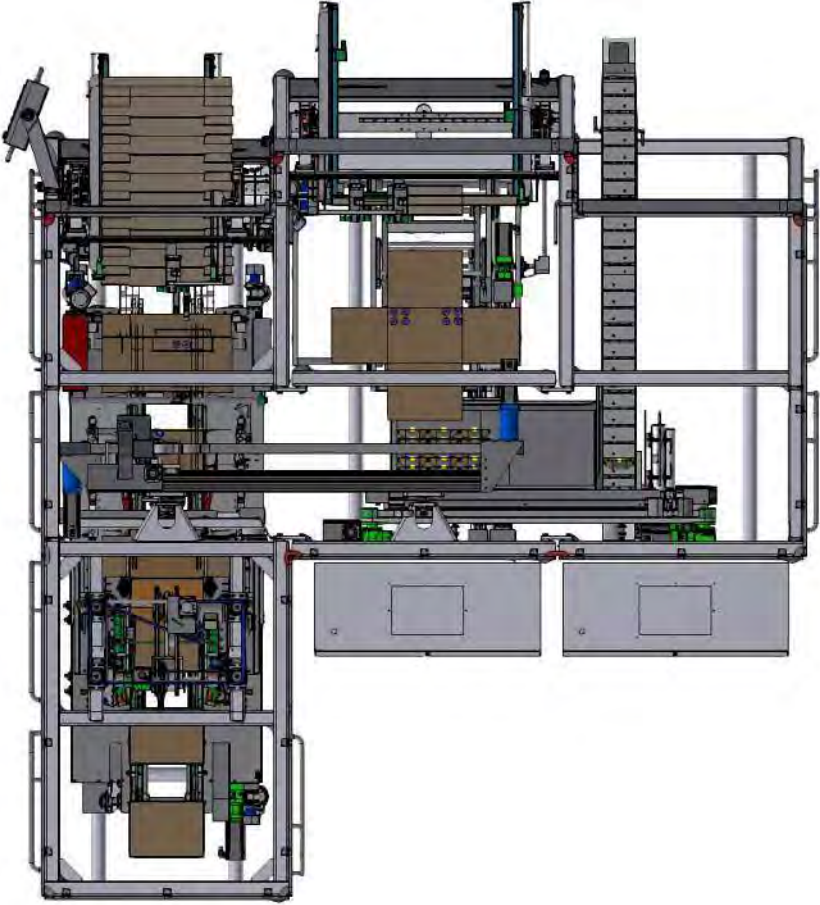
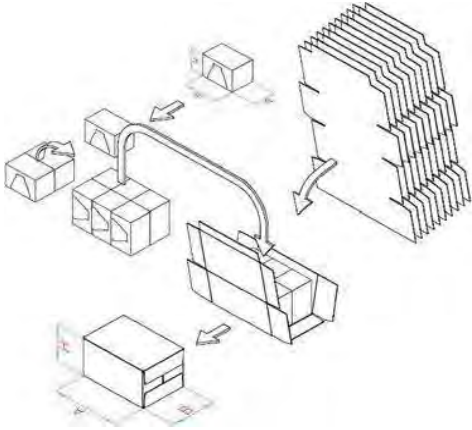

PALLETISATION SYSTEMS

- Single or multiple stations
- 4/5/6-axis robot for a precise product positioning on the pallet
- Customized picking heads, according to the product to be taken
- Layer formation and picking
- Empty pallet feeding system for prolonged autonomous management
- Centering systems for handling pallets with boxes or demi-boxes
- Possible integration with pallet wrapping systems and labelling machines
- Safety in product handling operations
- Space optimisation
- Compatibility with each kind of pallet (euro pallet, ½ pallet, American pallet ...)

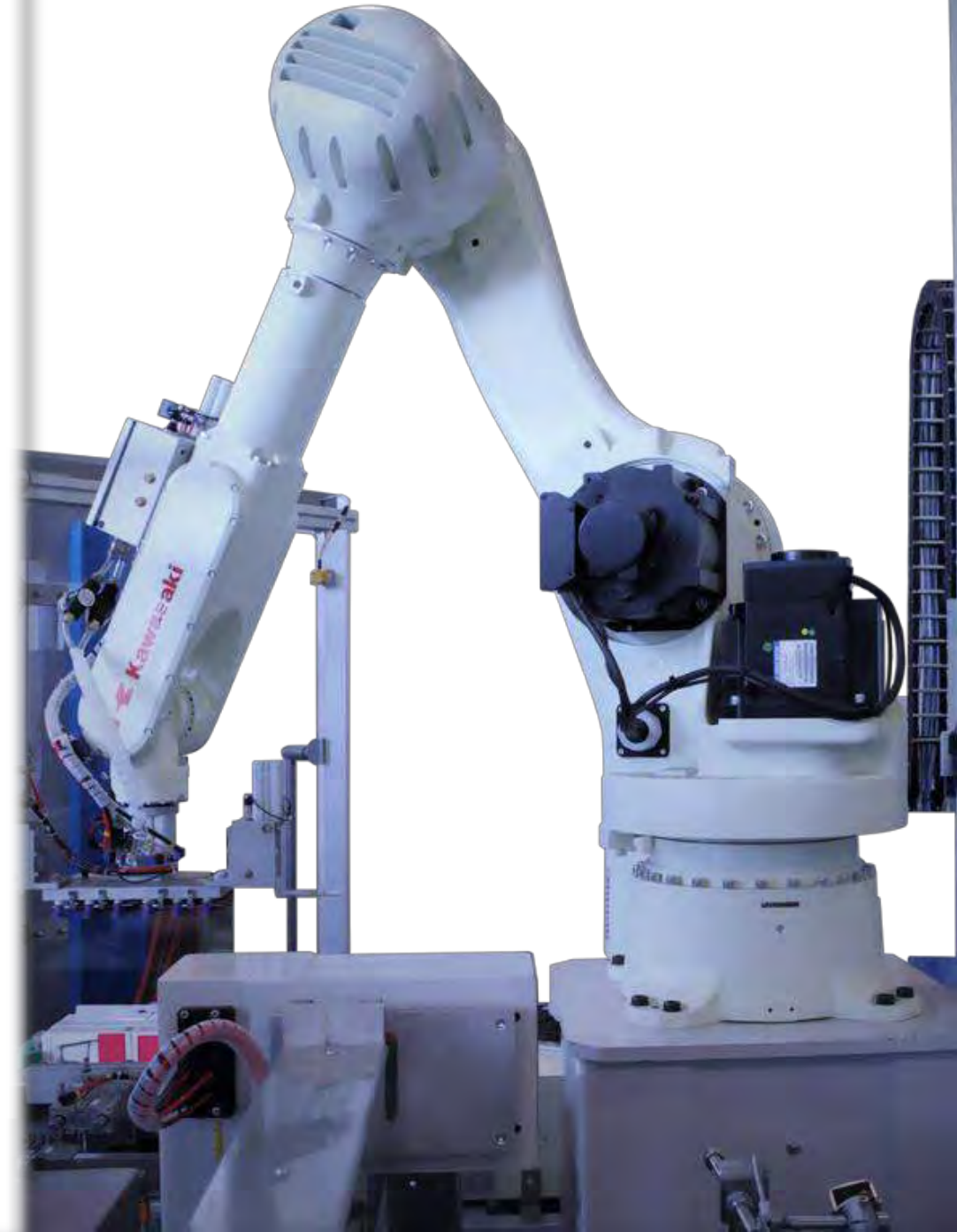

INTEGRATED SOLUTIONS

Mod. Pall-Wrap

- Wrap-around cardboard packaging modules integrated with palletising systems
- Compact solutions with reduced dimensions
- Space optimization
- Dedicated to low speed case packers (max. 6 cases/min)
- Automatic format change
- Use of 6-axis robots for product picking, packaging formation and palletising operations



GREEN SOLUTIONS

- Patented systems for the realization of plastic-free packages, with high quality standards
- Minimization of the use of packaging materials with a consequent reduction of waste and optimization of space
- Promotion of eco-friendly thoughts and practices, thanks to the study and creation of innovative machines for non-plastic packaging
- Collaboration with the main food processing and packaging companies, and more, increasingly attentive to reducing their environmental impact
- Encouragement of new types of packaging, with the aim of increasing awareness and empowering customers and end consumers
- Mod. MINI-TRAY, mod. I-LAYER, mod. ECO-LABEL



Cluster packing machine

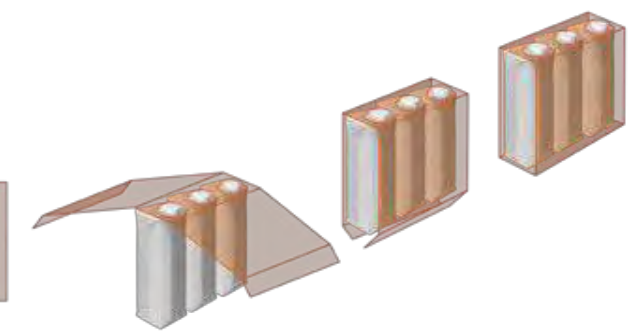
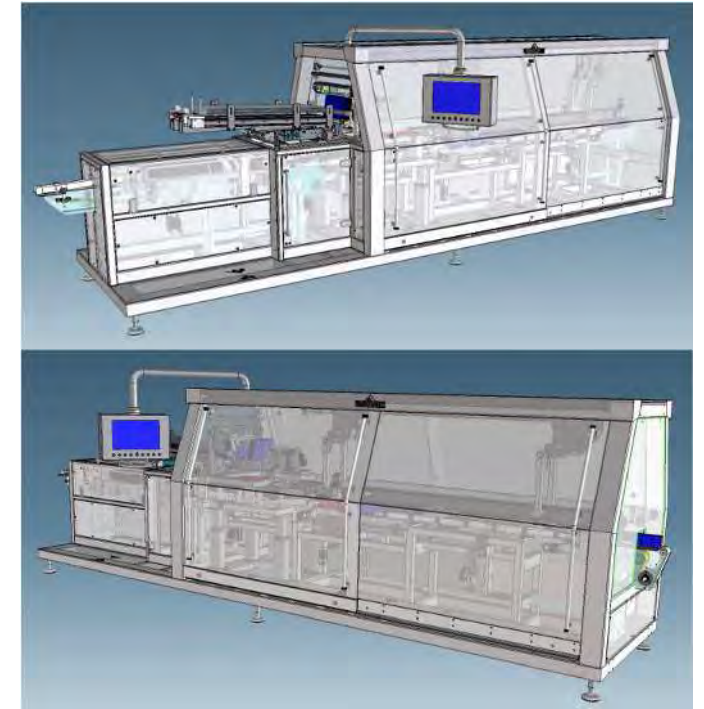
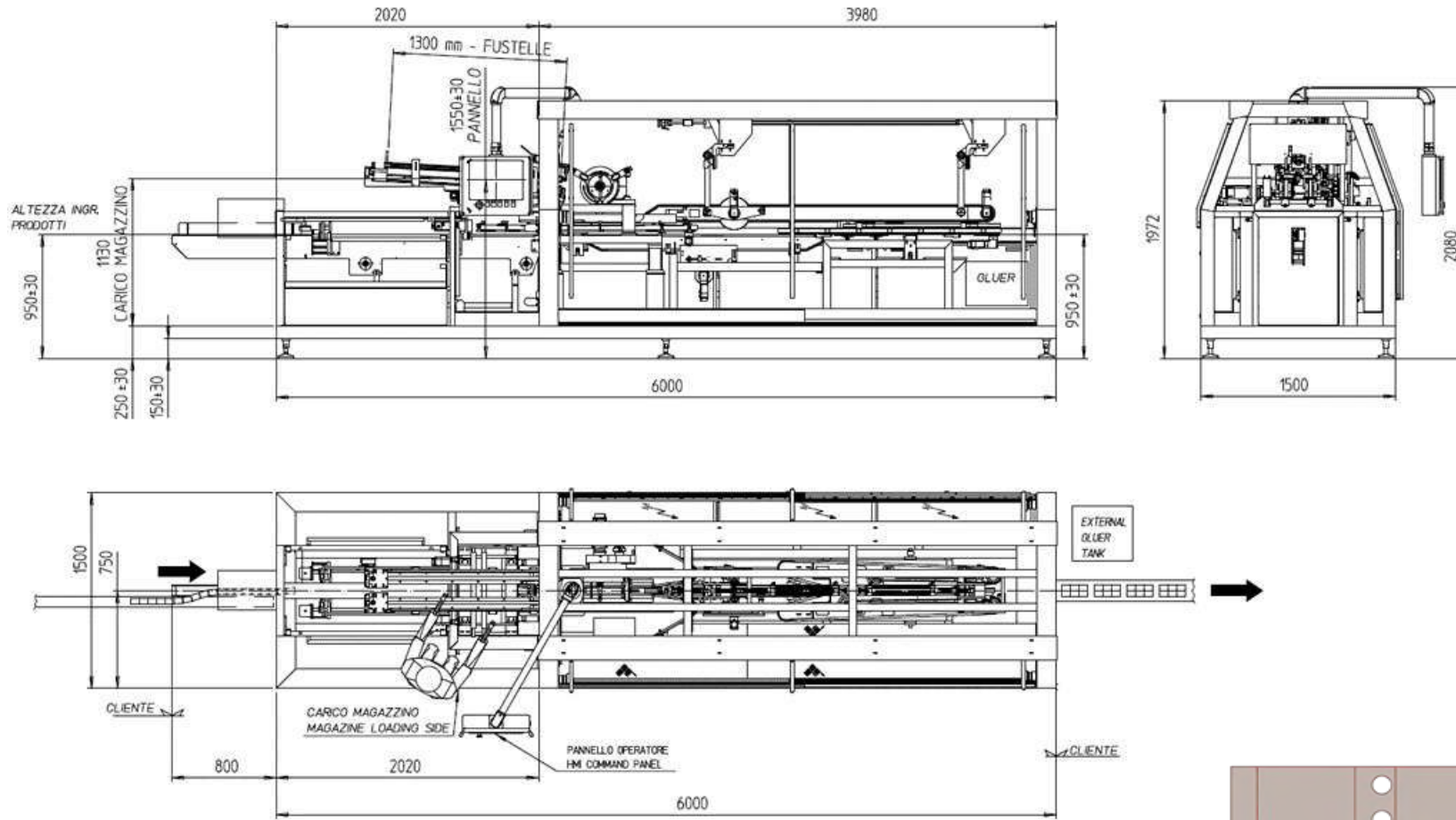

Rethinking processes from a sustainable perspective

Mini-tray

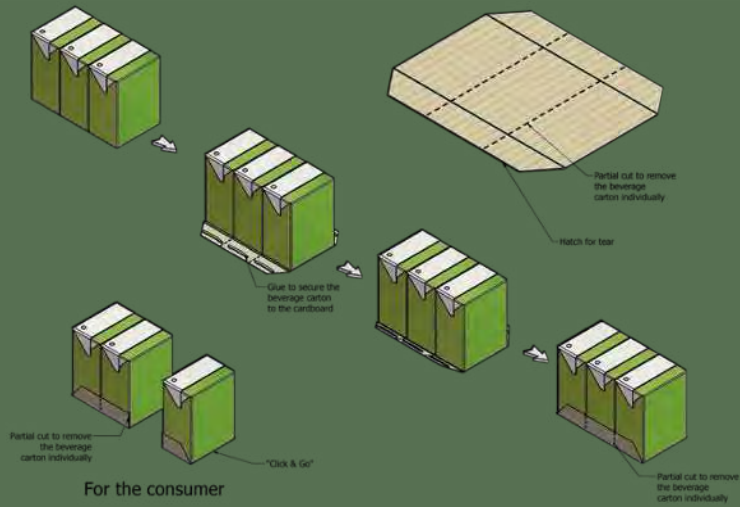

Eco-label

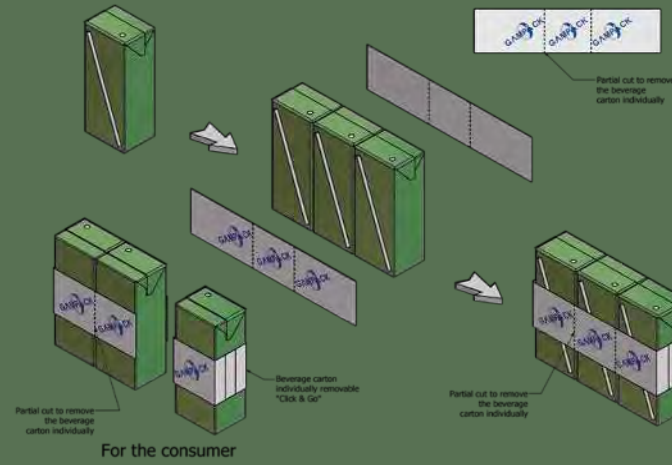

I-layer

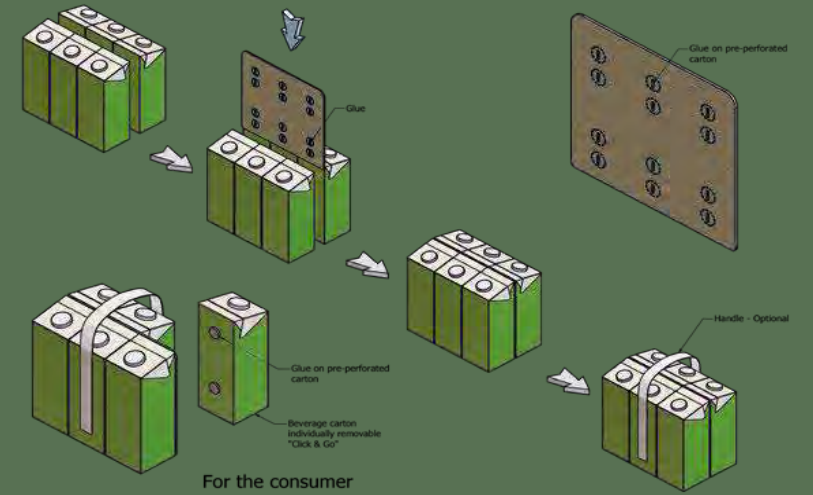



GAMPACK GROUP

Customizing Packaging Technology

Via Piemonte 1, 29122 Piacenza – Italy

Phone number +39 0523 554012

Email address info@gampackgroup.com

Website www.gampackgroup.com